

Ambient Units

The new Self Service Flexi System is an easily adaptable solution with compact dimensions to solve the problems of food service in any location (cafeterias, canteens, restaurants, schools, resorts, etc.). It is particularly suitable for traditional in-line systems and "free-flow" systems. All units have panels with beech wood finish (cherry wood, walnut and other personalization are available as special), two tilting tray sliders, wheels and wooden hinged doors. The **ambient units** can be used as work or display tops and the cupboards can be used as storage areas for crockery and other materials. The models detailed on this sheet are ambient units 750, 1125 and 1500 mm in length.



321001

- 304 AISI stainless steel top with rounded edges.
- The top provides ample displaying or workspace and may be specially ordered to suit more specific needs.
- The two tray slides are constructed in plain 304 AISI stainless steel and can be folded down to facilitate passage of the units through doorways.

- The panels and hinged doors on the operator side, for quick, easy and hygienic storage, and have a beech wood finish.
- All units are mounted on four wheels, 150 mm in height (two with brakes), but can be mounted on 150 mm high feet (as special).

- Optional tilting plinth can be installed to cover wheels or feet.
- All models comply with the standards required by the main international approval bodies and are CE marked.



Electrolux

321000, 321002, 321001

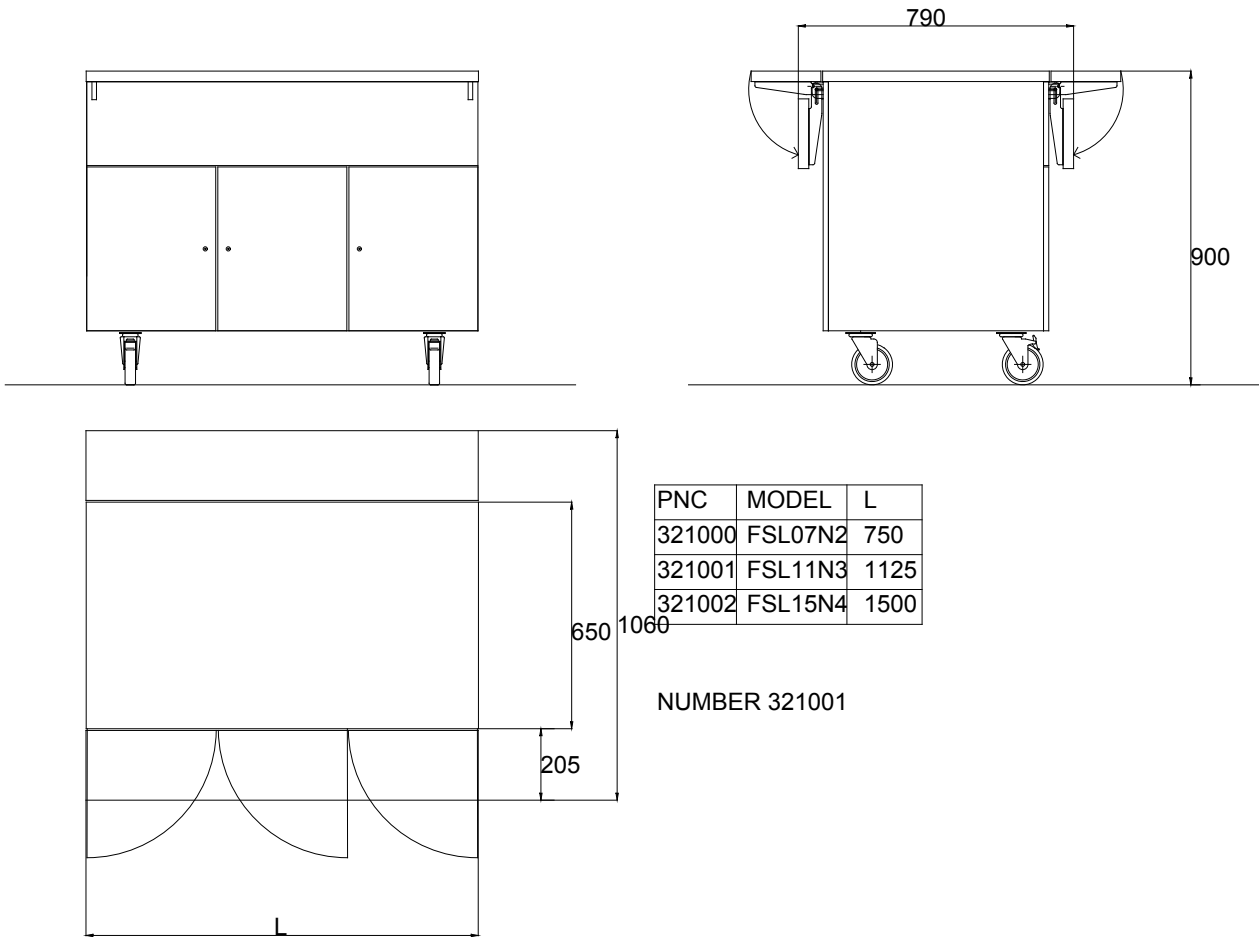

Flexi System

Ambient Units

FCA0010

2008-04-04

Subject to change without notice

	FSL07N2 321000	FSL11N3 321001	FSL15N4 321002
TECHNICAL DATA			
Neutral	●	●	●
External dimensions - mm			
width	750	1125	1500
depth	650	650	650
height	900	900	900
Net weight - kg.	40	50	60
ACCESSORIES			
KIT PLINTH FOR WHEELS 2GN - 750 MM	852003		
KIT PLINTH FOR WHEELS 3GN - 1125 MM		852006	
KIT PLINTH FOR WHEELS 4GN - 1500 MM			852007